

# THE SHOPS AT MILLPOND

New Port Richey, Florida

74,000 Sq. Ft.



## LOCATION

## FACTS / DEMOGRAPHICS

- ◆ THE SHOPS AT MILLPOND is located in New Port Richey at the intersection of State Road 54 and Rowan Road/Seven Springs Blvd.
- ◆ The Population exceeds 59,594 within 3 miles of the Center and within 5 miles of the site exceeds 122,283.
- ◆ The Average Household Income within 1 mile of this site exceeds \$45,454 and within 3 miles of the site exceeds \$41,517.
- ◆ Traffic count exceeds 75,000

# THE SHOPS AT MILLPOND

5277 Ehrlich Road Tampa, FL 33624

Leasing (813) 908-9754 Fax (813) 908-9794

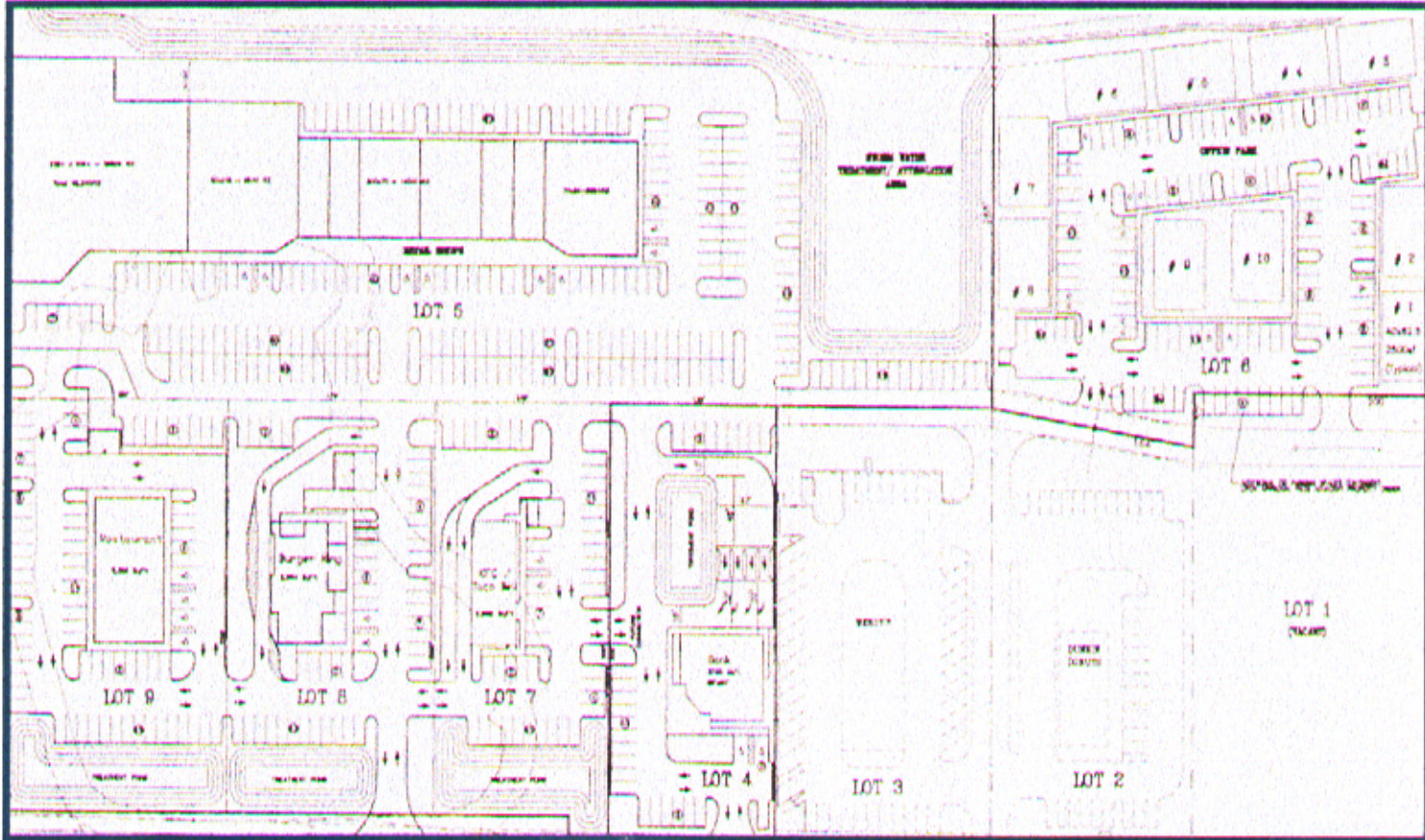

## FEATURES

- ◆ MILLPOND COLLECTIONS, LTD. depicts an upscale strip center anchored by Kash n' Karry, adjacent to a luxury/upscale retirement subdivision, near Seven Springs Estates and other Retail Development.
- ◆ The retail center will have 10ft store fronts and will be surrounded by Washingtonian Palms. Four out-parcels across the front will add traffic for the center.
- ◆ The SE corner will be 10-2500 sq. ft. office buildings overlooking peaceful and serene Millpond Lake. The office site is currently available.
- ◆ Hurry and call to reserve space now, while there's availability.

